

MAGNETIC SWITCH

PROGRAMMABLE SWITCH WITH INTERLOCK

The Magnetic Switch uses an electronic key to activate the outputs. The Switch has no moving parts, and is water proof. The Key consists of a DALLAS iButton fitted in a plastic key ring. The Key is factory programmed with an electronic combination code. Combination codes are available in T1, T2, T3, up to T255. A T1 key activates any factory programmed T1 Switch. A green LED is visible on the Switch when the key is accepted, or red LED when key is rejected. Imbedded in the Key is a magnet, used to latch on to the Switch to keep it in position until removed.

Mounting holes on the Magnetic Switch are designed to fit on any standard Onsetter or Banksman unit.

When the Switch is activated, the power output gives an internal electrical connection between the supply voltage (B+) and output terminal (OUT).

An optional Interlock feature provides 2 additional sets of normally open and closed dry contacts that can be switched simultaneously with the power output. The Key can be programmed to switch the power output, the interlock output, or both.

The Magnetic Switch is also ideal for any other application requiring controlled activation, such as operator machines, lathe's, door locks, electronic gates, etc.



Fitted Touch Switch Rear View Touch Key

CONNECTION DIAGRAM

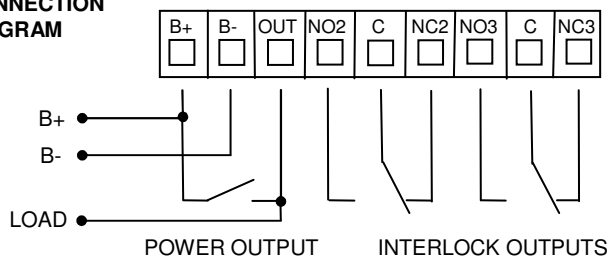

Features

- Supply voltage: 12VDC, 24VDC, 32VAC/DC or 110VAC
- Maximum load current: 8 Amp.
- Waterproof and dustproof stainless steel enclosure
- No moving parts on switch.
- Red LED indicates rejected Key
- Green LED indicates accepted key
- Switches and Keys are reprogrammable
- Unlimited Keys per switch
- Key latches magnetically to switch



Telbit reserves the right to change specifications without prior notice.

MOUNTING HOLES

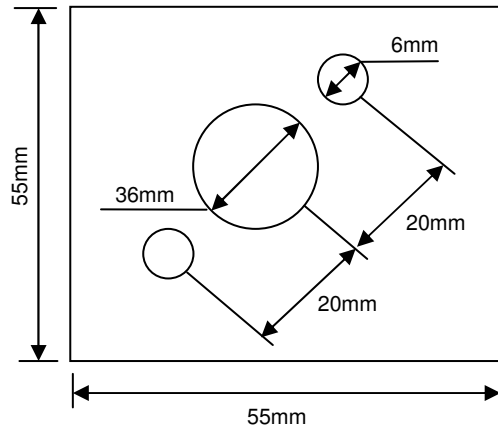

Telbit

29 Galaxy ave. Linbro Business Park
Sandton, South Africa
Tel: +27 11 608-1121
Fax: +27 11 608-1127
e-mail: sam@telbit.co.za